

## Tub Spout

- O15-VRV1B Finish(B)
- O15-VRV1BG Finish(BG)
- O15-VRV1C Finish(C)
- O15-VRV1D Finish(D)

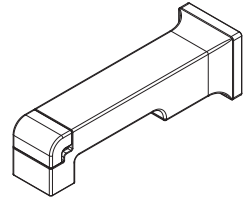

## Specifications

### Features

- All Metal Construction
- Unique Water Ribbon Flow
- Diverting Tub Spout
- Threaded 1/2" Male Copper Sweat Adapter Included (C X MNPT)
- Pforever Warranty®

### Code Compliance

Pfister products are designed and manufactured in compliance with the following standards and codes:

- IAPMO Certified to ASME A112.18.1/CSA B125.1
- CEC Certified/CALGreen compliant

## Dimensions

