

WWD30



**FEATURES**

- \_\_\_\_\_ Distributes heat evenly from 80 to 200 degrees Fahrenheit using fans
- \_\_\_\_\_ Includes food presets, such as bread, cooked cereals, and pizza
- \_\_\_\_\_ Tested and approved for warming towels
- \_\_\_\_\_ Fits entrées and sides easily in its generous 30 inch drawer cavity
- \_\_\_\_\_ Includes hidden electronic controls
- \_\_\_\_\_ Offers automatic shut-off

**ACCESSORIES**

- \_\_\_\_\_ 30" Stainless Professional Front Panel - 2" Thick
- \_\_\_\_\_ 36" Stainless Professional Front Panel - 2" Thick
- \_\_\_\_\_ 6-Piece Container Set
- \_\_\_\_\_ Contemporary Handle- E Series
- \_\_\_\_\_ Contemporary/Transitional Handle
- \_\_\_\_\_ Professional Handle-E Series
- \_\_\_\_\_ Professional Handle-M Series
- \_\_\_\_\_ Transitional Handle- M Series
- \_\_\_\_\_ Warming Drawer Front Panel - Integrated
- \_\_\_\_\_ Warming Drawer Front Panels - M Series
- \_\_\_\_\_ Warming Drawer Front Panels - E Series
- \_\_\_\_\_ Warming Drawer Front Panels - M Series
- \_\_\_\_\_ Warming Drawer Front Panels - E Series

Accessories available through an authorized dealer.  
 For local dealer information, visit [subzero-wolf.com/locator](http://subzero-wolf.com/locator).



**FRONT PANEL OPTIONS**



30" E SERIES TRANSITIONAL



30" E SERIES PROFESSIONAL



30" E SERIES CONTEMPORARY



30" M SERIES CONTEMPORARY



30" M SERIES TRANSITIONAL



30" M SERIES CONTEMPORARY STAINLESS



30" M SERIES PROFESSIONAL



30" L SERIES



30" INTEGRATED

**PRODUCT SPECIFICATIONS**

Model	WWD30
Dimensions	29 7/8"W x 10 3/8"H x 22 3/4"D
Capacity	1.6 cu. ft.
Electrical Supply	120 VAC, 60 Hz
Electrical Service	15 amp dedicated circuit
Power Cord Length	3 Feet
Receptacle	3-prong grounding-type

**ELECTRICAL**

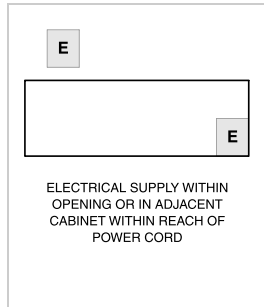

**INSTALLATION WITH FRONT PANEL** Accessory front panels may affect overall product dimensions and opening dimensions. Refer to [Reveal](http://subzero-wolf.com/reveal) for more information: subzero-wolf.com/reveal

**NOTE:** Dimensions in parenthesis are in millimeters unless otherwise specified

**DIMENSIONS**

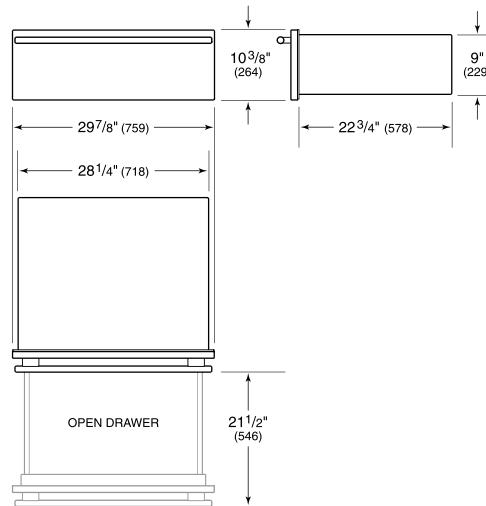

**STANDARD INSTALLATION**

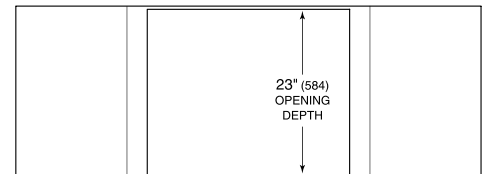

TOP VIEW

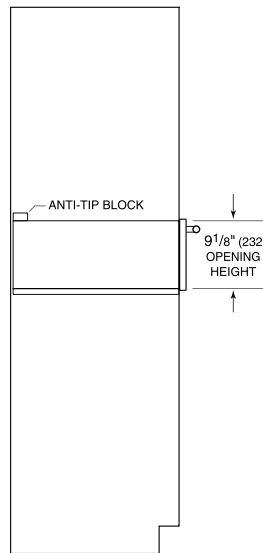

SIDE VIEW

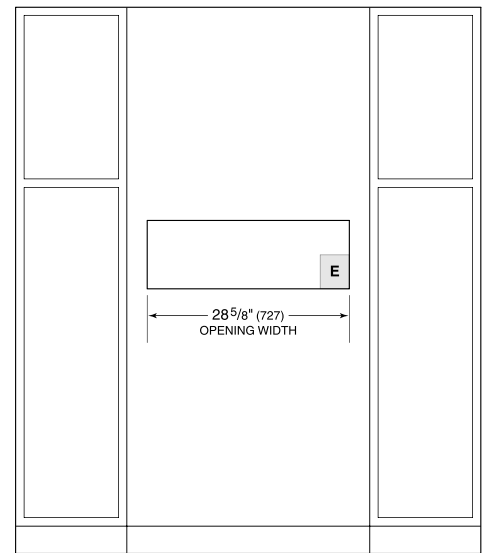

FRONT VIEW

**NOTE:** Location of electrical supply within opening may require additional cabinet depth.